

Consumer Products

Service Information

Date: 22 September 1983

Factory: John Deere Horicon Works



TR800 CLUTCH BUSHINGS

Complaint or Symptom:

M69328 roller arm loose and/or poor clutch performance.

Problem:

Moveable sheave bushing M68859 (A) and cover bushing M68862 (B) become loose in their housings and/or wear, causing accelerated wear of the arm roller bushings and their thrust washers.

Solution:

When replacing arm bushing M69329 (C), roller AM55473 (D), or thrust washers AM55474 (E) and AM55563 (F), always inspect moveable sheave bushing M68859 (A) and cover bushing M68862 (B). Replace bushings if worn, loose, or if staking is not secure. Install larger diameter washer M69706 (G) behind the spider if it has not already been installed.

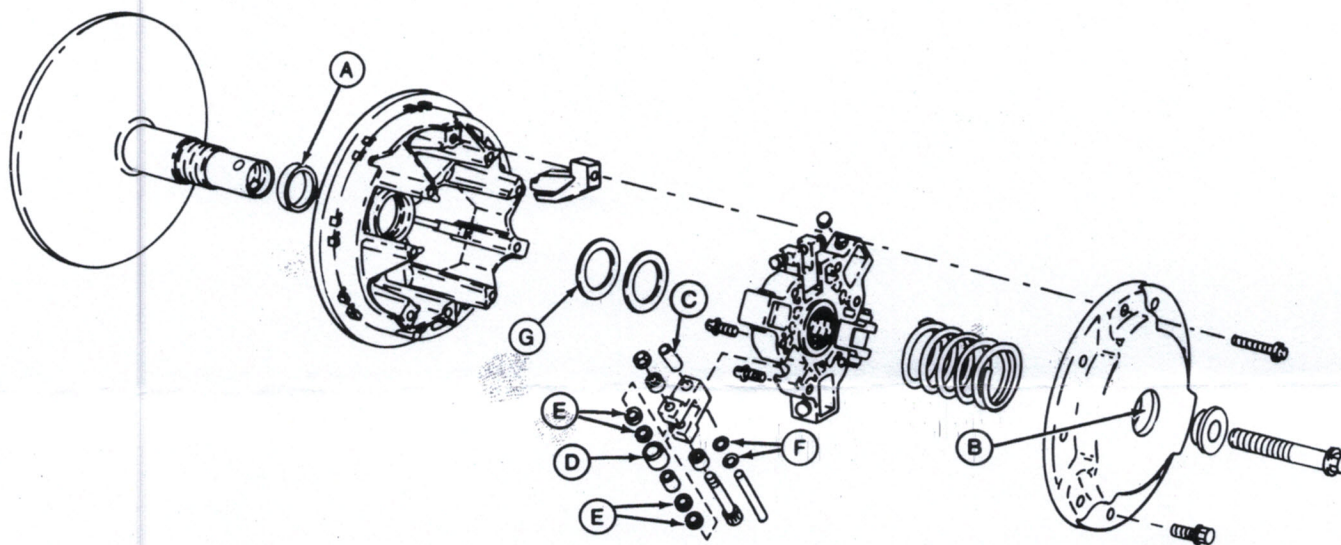

Please pass to:

Date

Return to: _____

Applies to:

Additional Information:

TR800 clutches used on 1982 Model Liquifires were produced with a black cover. The 1983 Model Liquifires were produced with TR800's having silver covers. Silver cover clutches had bushing M68859 loctited in place and improved staking. In addition, a running change during 1983 production put the larger diameter washer (M69706) behind the spider to prevent the staking from being worn away.